

OWNER'S MANUAL

Braemar Invertair™ - True Inverter Add-On Cooling Unit

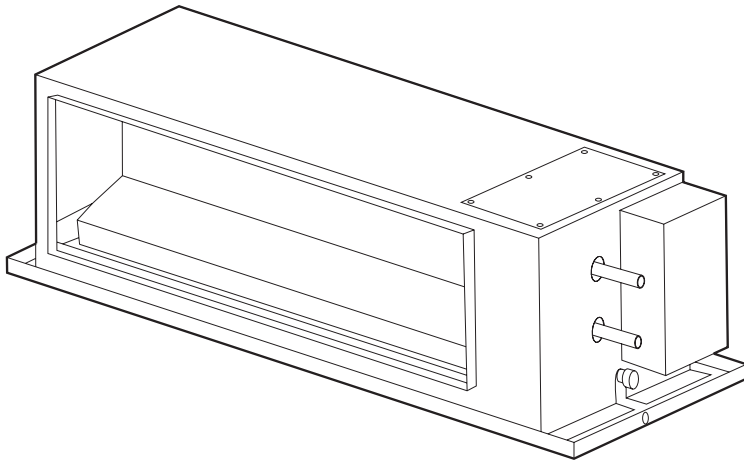

SACV10D1S / SCHV10D1S
SACV12D1S / SCHV12D1S
SACV14D1S / SCHV14D1S
SACV16D1S / SCHV16D1S

(English) (Invertair)

TABLE of contents

MAIN COMPONENTS	2
INTRODUCTION & SAFETY	3
MAGIQTOUCH CONTROLLER® SETTINGS MENU	4
About Appliance	4
Cooler Selection	4
Min/Max Set Temperature	4
Room Fan Run-On Time	4
OPERATION	5
Refrigerated Cooling Zoning	5
Connection to other Ducted Gas Heater Brands	5
MAINTENANCE & SERVICE	5
Air Filter	5
Indoor Coil	5
Outdoor Unit	5
Refrigerant	5
MAINTENANCE SCHEDULE	6
CHECK BEFORE CALLING FOR SERVICE	7
OPERATION TIPS	8
TROUBLESHOOTING GUIDE	9

WARNING! Failure to install and commission the product in compliance with these instructions, or failure to do the job properly and competently, may void the customer's warranty. Further, it could expose the Installer and/or the Retailer to serious liability.

MAIN COMPONENTS

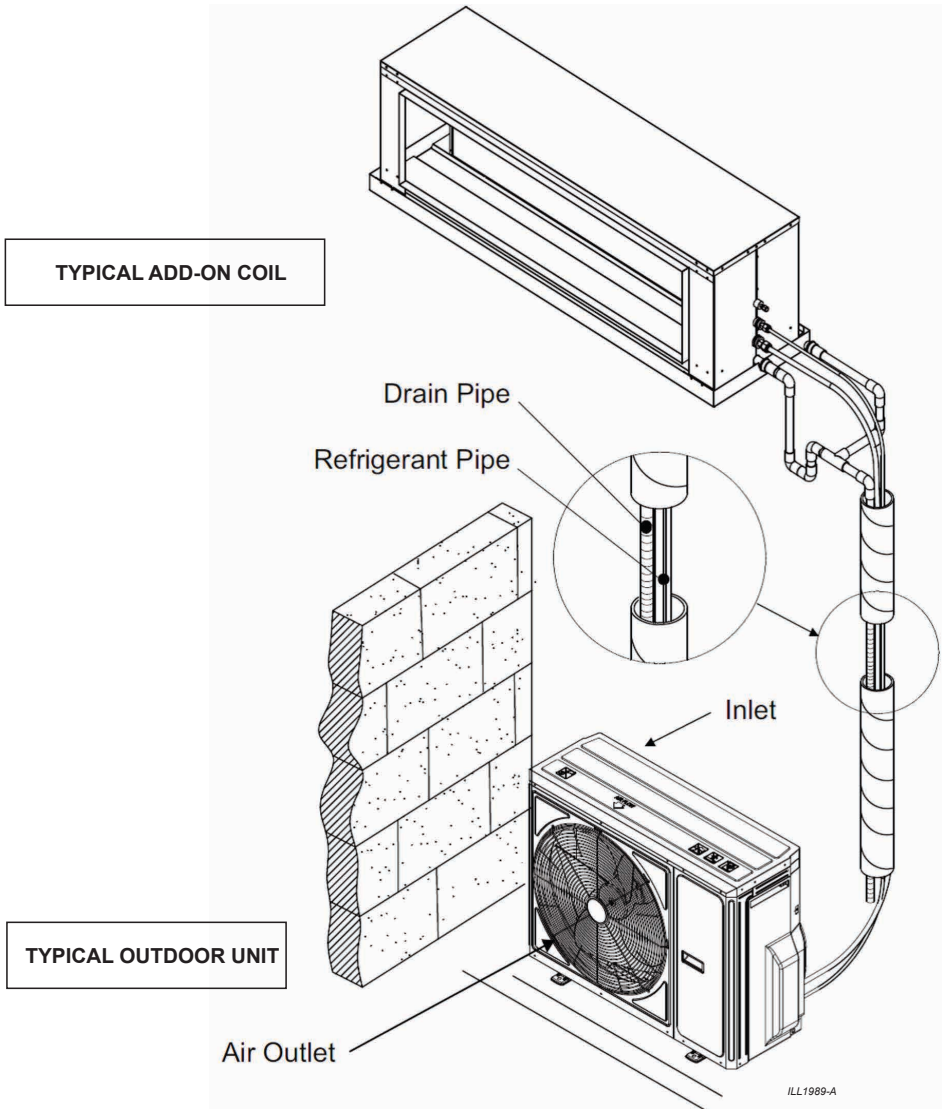

Indoor and Outdoor unit operating temperature range:

Indoor Unit	Outdoor Unit
18°C - 30°C	-15°C - 48°C

INTRODUCTION & SAFETY

Congratulations on purchasing a new Braemar Invertair™ - True Inverter Add-On Cooling unit!

Please keep this Manual and the Warranty Booklet in a safe place, along with the original purchase documents, plus all relevant certificates of compliance relating to the installation work performed. Please register the Warranty straight away, by following the steps set out in the Warranty Booklet.

The Braemar Invertair™ - True Inverter Add-On Cooling unit is a refrigerated cooling only, split type air conditioning system, designed specifically for connection to a Braemar "TQ/TQM Extra Air" Series gas ducted heating unit, using MagIQtouch Controller.

The installer must read the Installation Manual before installing the Braemar Invertair™ - True Inverter Add-On Cooling unit. The home owner/user should read the Owner's Manual before operating the unit.

To ensure the warranty on the unit is continued and valid, the unit must be checked and serviced by the home owner/user as per the requirements in the Maintenance & Service section and the Maintenance Schedule. This will also prolong the life of your air conditioner.

The home owner/user should regularly check the Air Inlet side of the Outdoor unit (see the diagram on page 1) to ensure grass, leaf and other matter are not drawn into or onto the Inlet side of the Outdoor unit. Restriction to the air flow across the coil will reduce the system's capacity, and result in high operation pressures and excessive operating costs.

A return air filter **MUST** be installed by the installer at the return air grille. The air filter should be inspected and cleaned at least every two weeks during summer or other periods when the Braemar Invertair™ - True Inverter Add-On Cooling unit is used.

Note: the manufacturer recommends that low level return air grilles are installed.

Important! THE AUSTRALIAN GREENHOUSE OFFICE HAS ISSUED VARIOUS REGULATIONS ON THE USE AND DISPOSAL OF REFRIGERANTS IN THE UNIT. FAILURE TO FOLLOW THESE REGULATIONS MAY HARM THE ENVIRONMENT AND COULD LEAD TO THE IMPOSITION OF SUBSTANTIAL FINES.

WHERE SPECIFIED, ONLY QUALIFIED AND LICENSED TECHNICIANS SHOULD PERFORM WORK ON THIS UNIT, FAILING WHICH THE WARRANTY ON THE UNIT WILL BE VOID.

WARNING! This appliance is not intended for use by persons (including children) with reduced physical, sensory or mental capabilities, or lack of experience and knowledge, unless they have been given supervision or instruction concerning use of the appliance by a person responsible for their safety. Children should be supervised to ensure that they do not play with the appliance.

If the supply cord is damaged, it must be replaced by a Seeley service agent or similarly qualified person in order to avoid a hazard.

MAGIQTOUCH CONTROLLER® SETTINGS MENU

Your MagIQtouch Controller contains a settings menu which gives you access to information about your Braemar Invertair™ - True Inverter Add-On Cooling unit and to extra functions including:

ABOUT APPLIANCE

Access information about the appliances installed in your system.

COOLER SELECTION

If you have both an Evaporative Cooler and Invertair™ True Inverter Add-On Cooling unit installed, you can select which product to use for cooling mode.

MIN/MAX SET TEMPERATURE

You can change the minimum and maximum temperature displayed on your slider, depending on what temperature range you prefer your system to work within.

ROOM FAN RUN-ON TIME

You can select whether to have the fan on "Continuous" or select a specific "Run-on Time" when the compressor stops.

Note! There are some settings that are just for trained service agents or installers. You won't be able to access any of these options without a pin code.

Here's a brief visual guide to get you started quickly!
Refer to the MagIQtouch Wall Control Owner's Manual for detailed instructions.

STEP 1

Activate screen.

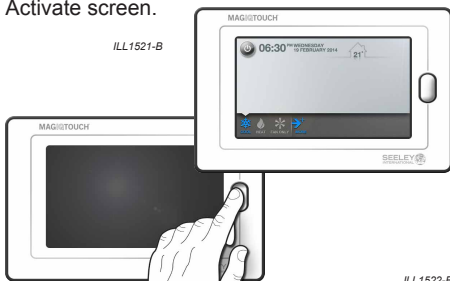

STEP 2

Select mode from lower taskbar.

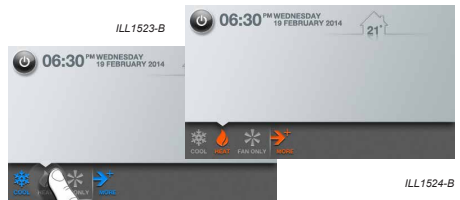

STEP 3

Turn on cooler or heater.

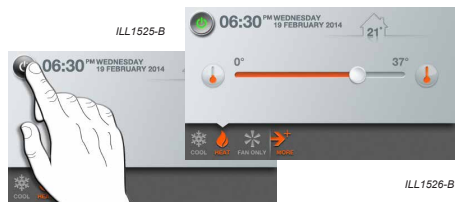

STEP 4

Set desired temperature.

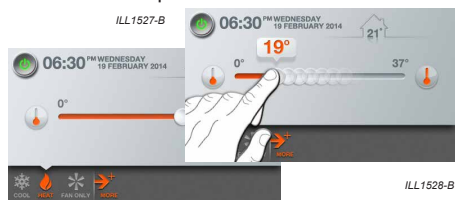

STEP 5

Access more advanced options by expanding the lower taskbar.



STEP 6

Access wall control and system settings in the SETTINGS menu.



OPERATION

Your Braemar Invertair™ - True Inverter Add-On Cooling unit has been designed and built with reliable, quality components. To ensure many years of trouble free, dependable service please read the following pages very carefully, and please ensure that you follow all of the instructions.

Please refer to your Braemar Ducted Gas Heater Home Owner's Manual for the setting and operation of your Braemar Invertair™ - True Inverter Add-On Cooling unit.

REFRIGERATED COOLING ZONING

TQ3 Series

The TQ3 Series of Braemar Ducted Gas Heaters are not designed for zoning, and when operated all outlets will be open for heating. If a Braemar Invertair™ - True Inverter Add-On Cooling unit is connected, then when it is operating all outlets will be open for cooling. Accordingly, if you choose to have a zoning control system fitted to your TQ3 Series Heater, then because it has not been designed for zoning, you may be disappointed with the heating and the cooling performance. However, any issues will need to be referred back to the supplier and/or installer of the zoning control system.

CONNECTION TO OTHER DUCTED GAS HEATER BRANDS

The Braemar Invertair™ - True Inverter Add-On Cooling unit is not suitable to be connected to other brands of ducted gas heaters.

MAINTENANCE & SERVICE

AIR FILTER

It is important to check and clean the air filter as per the Maintenance Schedule below. A dirty air filter will not allow the correct amount of clean air to pass through your air conditioner, resulting in poor performance and increased running costs. You should ask the installer to show you where the air filter is located.

To clean the air filter, it should be removed and then cleaned with a water hose using moderate pressure, spraying from the internal side. Make sure it is completely dry before refitting it. If it is very dirty and cannot be cleaned, the filter will need replacing. You should never operate the air conditioner without the air filter in place.

INDOOR COIL (Refer page 2)

The indoor coil does not have any moving parts, but it is advisable to have the drain and duct connections checked on an annual basis (as set out in the Maintenance Schedule below). Drains can become blocked by insects, and rats have been known to chew through the drain to get to the water in the pipe.

OUTDOOR UNIT (Refer page 2)

The Outdoor unit has either one or two fans, and draws air through the appliance to expel the heat generated during the cooling cycle. We recommend checking that plants haven't grown into or around the air intake or outlet, along with other debris that may build up over time, namely, leaves and the like.

REFRIGERANT

The refrigerant is the life blood of your air conditioning unit. Not only does the correct refrigerant charge provide you with reliable and economical cooling, it also provides the cooling for the compressor. A lack of refrigerant, due to a leak, will cause the compressor to overheat and expire prematurely. You will notice a decline in cooling effect and an increase in power consumption. Therefore, having a qualified, licensed technician service your air conditioner will save you money in the long term.

PLEASE REFER TO THE NEXT PAGE FOR THE MAINTENANCE SCHEDULE

MAINTENANCE SCHEDULE

Installation Date:	Installer:
--------------------	------------

Items to be done by the Home Owner/User (please sign in the places indicated)							
	Monthly	Annually	Year 1	Year 2	Year 3	Year 4	Year 5
Air filter cleaning	✓						
Air filter replacement		✓					
Maintain required clearance around Outdoor unit		✓					

Items to be done by a Qualified Licensed Technician (Home owner/user must ensure that the technician signs and dates in the places indicated)	
	Annually
Check, clean or replace filter	✓
Check drain from indoor coil	✓
Check Outdoor unit clearances – maintain garden and debris	✓
Check refrigerant charge	✓
Check refrigeration connections for soundness	✓
Check outdoor fans	✓
Check electrical connections	✓
Check ductwork (including but not limited to: duct, fittings, zone dampers, grilles)	✓
Check overall installation	✓
Report to the home owner/user all tasks that require attention	✓

Year 1 – Date:	Technician:
Year 2 – Date:	Technician:
Year 3 – Date:	Technician:
Year 4 – Date:	Technician:
Year 5 – Date:	Technician:

Please NOTE! the Maintenance Schedule covers Year 1 to Year 5. To preserve your investment for many years afterwards, we strongly recommend that you continue to maintain and service the Braemar Invertair™ - True Inverter Add-On Cooling unit as per the items and frequency set out in the Schedule, and as indicated elsewhere in this manual.

CHECK BEFORE CALLING FOR SERVICE

Before calling Service, please check the following:

1. If a new installation, please contact the installer to ensure the installation has been completed and commissioned.
2. Your system **MUST** have a **MagIQtouch Controller**, if not, please refer back to your installer.
3. Does the display show any information?
 - a. If Yes, go to Step 4.
 - b. If No, check power supply to Heater.
 - I. Repair power supply and set time and day.
 - II. Follow procedure in your Braemar Ducted Gas Heater Owner's Manual on how to set up and operate your system.
 - III. After completing the above checks and rectifying any fault as required, if your appliance continues not to operate, please call **1300 650 644**.
4. Is the MagIQtouch Controller set to "COOL" mode?
 - a. If Yes,
 - I. Is there air coming out of the outlets in your home?
 - II. If No,
 1. Ensure MagIQtouch Controller is set to COOL and the set point is below the room temperature.
 2. Check and clean return air filter.
 3. Check and open outlets and/or zones.
 4. Check duct for disconnection or damage.
 5. After the above have been checked and repaired as required, please call **1300 650 644**.
 - b. If Yes, continue below:
 - I. Check Circuit Breaker and/or Isolator to Invertair Outdoor unit, Invertair Indoor unit and Ducted Gas Heater. If electricity is available, the unit may be timing out on the inbuilt safety timer. Wait 5 minutes and re-check.

II. If fan is blowing on Outdoor unit, check large pipe's temperature, this pipe should be cold to touch. If not cold, please have the installer check for refrigerant leaks before calling Braemar Service on **1300 657 506**.

5. Does the Invertair Add-On Cooling unit run for short periods of time?
 1. If No, refer 4.a.ii above
 2. If Yes,
 - a. Check to ensure enough outlets are open.
 - b. Check and clean return air filter.
 - c. The Invertair™ True Inverter Add-On Cooling unit has special safety features built in to protect the system. It will switch off the Add-On Cooling unit output signal when the supply air temperature drops below a pre-set minimum value and will restart after the supply air temperature rises by a pre-set value.
 - d. Call the installer to check you have the required number of outlets open.
 - e. Once the above have been checked and repaired as required, call **1300 657 506**.

Please NOTE!

It is important that you recognise whether the fault is with the Ducted Gas Heater or if the fault is with the Braemar Invertair™ - True Inverter Add-On Cooling unit. For prompt, efficient service, please follow the above before calling the appropriate number below.

For Refrigerated Cooling Issues
1300 657 506

For Ducted Heater Issues
1300 650 644

When calling the Warranty Service number, please ensure you have your model and serial number available, along with date of purchase, and if possible a description of the problem.

OPERATION TIPS

The following events may occur during normal operation:

1. Protection of the air conditioner.

Compressor protection

- The compressor cannot restart for 3 minutes after it stops.
- The supply air drops below a pre-determined set point; this prevents the indoor coil from freezing.

2. A white mist coming out from the Indoor unit.

- A white mist may generate due to a large temperature difference between air inlet and air outlet on COOL mode in an indoor environment that has a high relative humidity.

3. Low noise of the air conditioner.

- You may hear a low hissing sound when the compressor is running or has just stopped running.

This sound is the sound of the refrigerant flowing or coming to a stop.

- You can also hear a low “squeak” sound when the compressor is running or has just stopped running.

This is caused by heat expansion and cold contraction of the plastic parts in the unit when the temperature is changing.

OPERATION TIPS cont.

4. Dust is blown out from the Indoor unit.

This is a normal condition when the air conditioner has not been used for a long time or during first use of the unit.

5. A peculiar smell comes out from the Indoor unit.

This is caused by the Indoor unit giving off smells permeated from building material, from furniture, smoke (for example if someone is cooking food), or from the duct work.

6. FAN operation during COOL mode.

When indoor air temperature reaches the setting on the MaglQtouch Controller, the compressor will stop operating and after approximately 60 seconds the indoor fan will stop blowing air. When the room temperature rises back to the set point, the indoor fan and the compressor will start again.

TROUBLESHOOTING GUIDE

Symptom	Cause	Action
The air conditioner does not run	Power failure.	Wait for power to resume.
	Fuse blown or circuit breaker open.	Replace the fuse or reset the breaker.
	Thermostat adjustment too high (in cooling mode).	Check thermostat setting.
There is insufficient cooling	The room was probably very hot when you started the system.	Wait a while so the unit has enough time to cool the room.
'Clicking' sound is heard from the air conditioner	In heating or cooling operation any plastic parts may expand or shrink due to a sudden temperature change in this event, a clicking sound may occur.	This is normal.

Note!

Seeley International strives for continuous product improvements, therefore specifications are subject to change without notice. Unit colour may vary slightly from that depicted in this booklet.

Installation and commissioning of this system to the manufacturer's specification, and compliance with industry standards, and local, state and national regulatory codes, are the responsibility of the installer.

Information in this booklet was true and correct at the time of publishing. E & OE



Warranty Service
Refrigerated Cooling 1300-657-506
Ducted Gas Heating 1-300-650-644
seeleyinternational.com

It is the policy of Seeley International to introduce continual product improvement.
Accordingly, specifications are subject to change without notice.
Please consult with your dealer to confirm the specifications of the model selected.